

20132

Agenda Items
13-17



May 28, 2026,
Office of County Commissioners
PO Box 1097
Greenville, TX 75403

Overhead Maintenance/ Pole Installations
Project Number: WO 30637396ID 12876

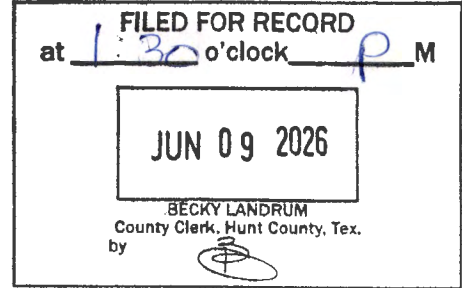

Hello,

Oncor Electric Delivery LLC., is requesting permission to do work within the county right of way along the following county roads. County Road 1061, 1076, 1118, 1122, & 1098. Oncor is proposing new pole installations/replacements and performing aerial maintenance work at existing locations.

If you have any questions, please contact at any time.

Sincerely,

Joshua Rogers

Distribution Permitting Specialist

Johua.rogers@oncor.com

Phone: 682-999-1045

County Approval Section:

Approved: _____ Denied: _____

Authorized Signature: _____ Date: _____

S102 – Reconductor to 3P 795 AAC from GPS (33.2667978,-96.2406353) to (33.2672921,-96.2404921), or structure ID (1849664-6706534) to (3326729-09624051). Trip Saver in SXXX will be installed where conductor size changes back to 3P #2 ACSR.

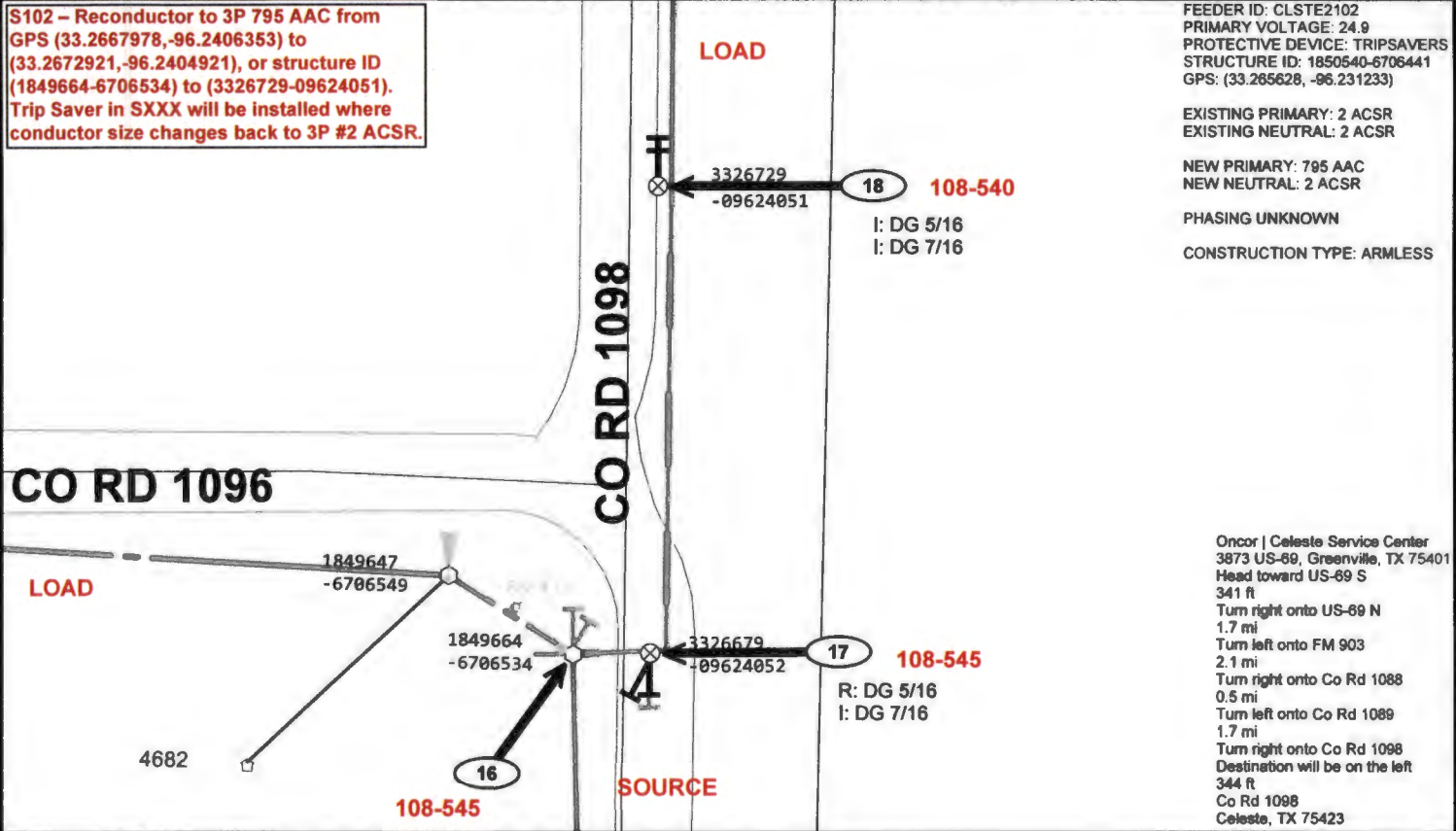

FEEDER ID: CLSTE2102
 PRIMARY VOLTAGE: 24.9
 PROTECTIVE DEVICE: TRIPSAVERS
 STRUCTURE ID: 1850540-6706441
 GPS: (33.265628, -96.231233)

EXISTING PRIMARY: 2 ACSR
 EXISTING NEUTRAL: 2 ACSR

NEW PRIMARY: 795 AAC
 NEW NEUTRAL: 2 ACSR

PHASING UNKNOWN

CONSTRUCTION TYPE: ARMLESS

Oncor | Celeste Service Center
 3873 US-69, Greenville, TX 75401
 Head toward US-69 S
 341 ft
 Turn right onto US-69 N
 1.7 mi
 Turn left onto FM 903
 2.1 mi
 Turn right onto Co Rd 1088
 0.5 mi
 Turn left onto Co Rd 1089
 1.7 mi
 Turn right onto Co Rd 1098
 Destination will be on the left
 344 ft
 Co Rd 1098
 Celeste, TX 75423

ELECTRIC CONSTRUCTION PRINT

WO Number: 30637396-01	Date: 2026/04/28	Description: CEL SRP26 CLSTE2102 DA_N PRG B ESTABLISH FEEDER BACKSTAND NWF PT1
Sheet: 7 of 7	Scale: 1"=20'	Customer:
Job Status: Design	Svc Ctr / Office: CEL/	Address: CELESTE
Designer: RODRIGUEZ, EDDY C/UBEM	469-955-7718	Location: WS-16: (33.2667978,-96.2406353)
Project Mgr: /		My Supervisor: Luke McGrath TechServ Engineering & Consulting Project Coordinator (405) 826-8124 LMcGrath@TechServ.com Luke.McGrath@Oncor.com

Copyright 2018 Oncor Electric Delivery - Maps, drawings, and electronic data (products) are created for the internal purposes of Oncor Electric Delivery with no implication of suitability or fitness for the intended use of the recipient. Oncor Electric Delivery will make good faith efforts to provide products that are free from error, but does not warrant the accuracy or quality of such products. The locations shown are approximations and are not intended to show exact locations. Products provided to other parties by Oncor Electric Delivery are for the internal use of the recipient, and the recipient agrees not to duplicate or distribute the products or any portion of the products to third parties without the prior written permission of Oncor Electric Delivery. The recipient further agrees to hold harmless and indemnify Oncor Electric Delivery against all claims, costs, expenses and damages resulting from or predicated upon strict liability for personal injuries, death or property damage, on account of any defect in the property provided hereunder.



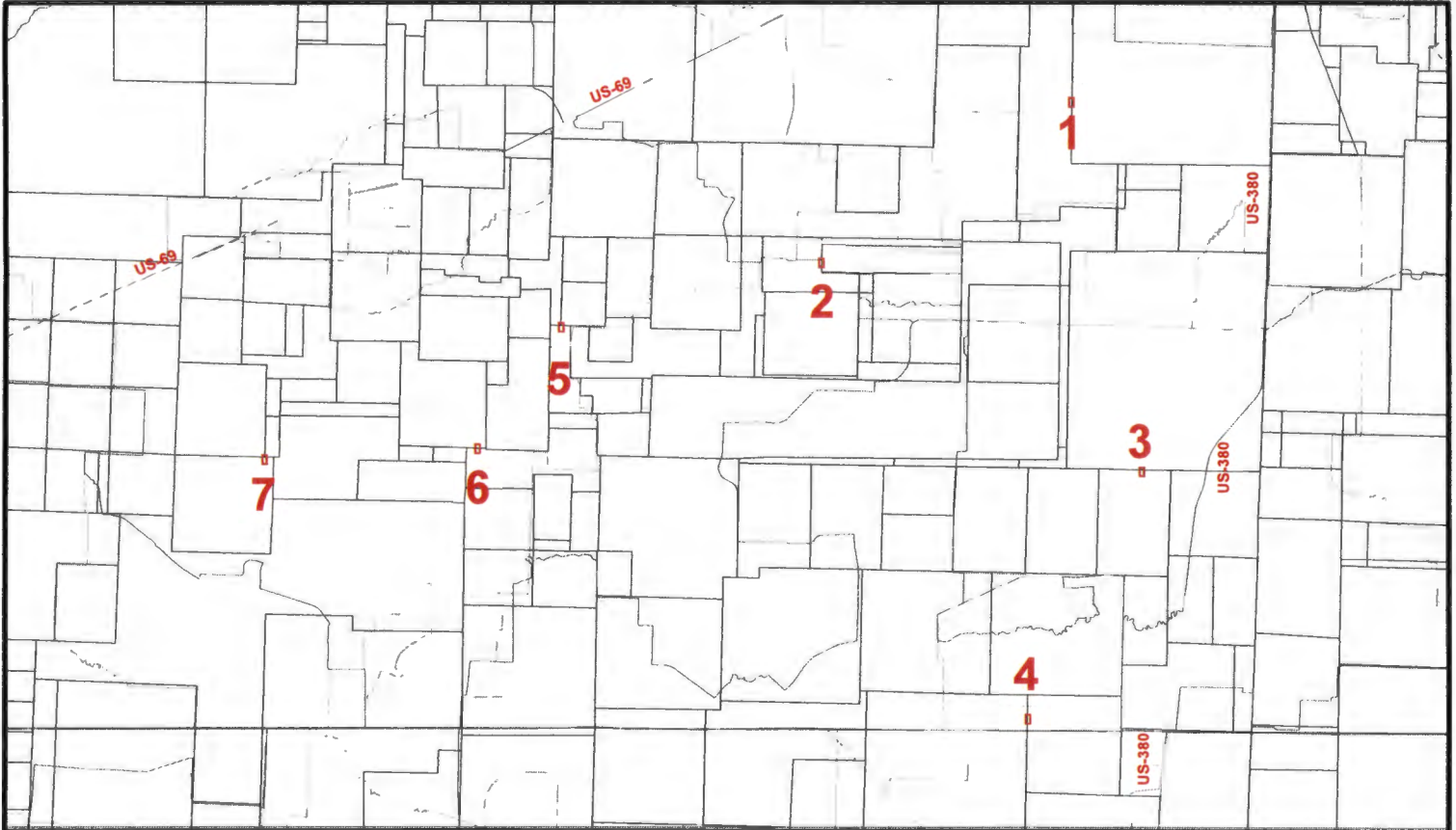

ELECTRIC CONSTRUCTION KEY MAP



WO Number: **30637396-01**

Date: **2026/04/29**

Description: **CEL SRP26 CLSTE2102 DA_N PRG B ESTABLISH FEEDER BACKSTAND NWF PT1**

Sheet: **KEY**

Scale: **1"=3000'**

Customer:

**My Supervisor: Luke McGrath
TechServ Engineering & Consulting
Project Coordinator
(405) 826-8124**

Job Status: **Design**

Svc Ctr / Office: **CEL/**

Address: **CELESTE**

**LMcGrath@TechServ.com
Luke.McGrath@Oncor.com**

Designer: **RODRIGUEZ, EDDY C/UBEM**

469-955-7718

Location:

Project Mgr: **/**

Copyright 2018 Oncor Electric Delivery - Maps, drawings, and electronic data (products) are created for the internal purposes of Oncor Electric Delivery with no implication of suitability or fitness for the intended use of the recipient. Oncor Electric Delivery will make good faith efforts to provide products that are free from error, but does not warrant the accuracy or quality of such products. The locations shown are approximations and are not intended to show exact locations. Products provided to other parties by Oncor Electric Delivery are for the internal use of the recipient, and the recipient agrees not to duplicate or distribute the products or any portion of the products to third parties without the prior written permission of Oncor Electric Delivery. The recipient further agrees to hold harmless and indemnify Oncor Electric Delivery against all claims, costs, expenses and damages resulting from or protracted upon strict liability for personal injuries, death or property damage, on account of any defect in the property provided hereunder.

**S19 - Remove Nova 372499
And install (3) 900A NO ABS
GPS: 33.1699048, -96.1728847**

**Nova 372499 is a future install
and is not in field yet**

FEEDER ID: CLSTE2102
PRIMARY VOLTAGE: 24.9
PROTECTIVE DEVICE: SUBSTATION BREAKER
STRUCTURE ID: 3318862-09617211
GPS: (33.186464, -96.171998)

EXISTING PRIMARY: 477 AAC
EXISTING NEUTRAL: 4 ACSR

PHASING UNKNOWN

CONSTRUCTION TYPE: SHIELDED

Oncor | Celeste Service Center
3873 US-69, Greenville, TX 75401
Head toward US-69 S
341 ft
Turn left onto US-69 S
4.9 mi
Turn right onto FM1569
2.2 mi
Turn left onto Co Rd 1061
Destination will be on the right
0.2 mi
1994 Co Rd 1061
Greenville, TX 75401

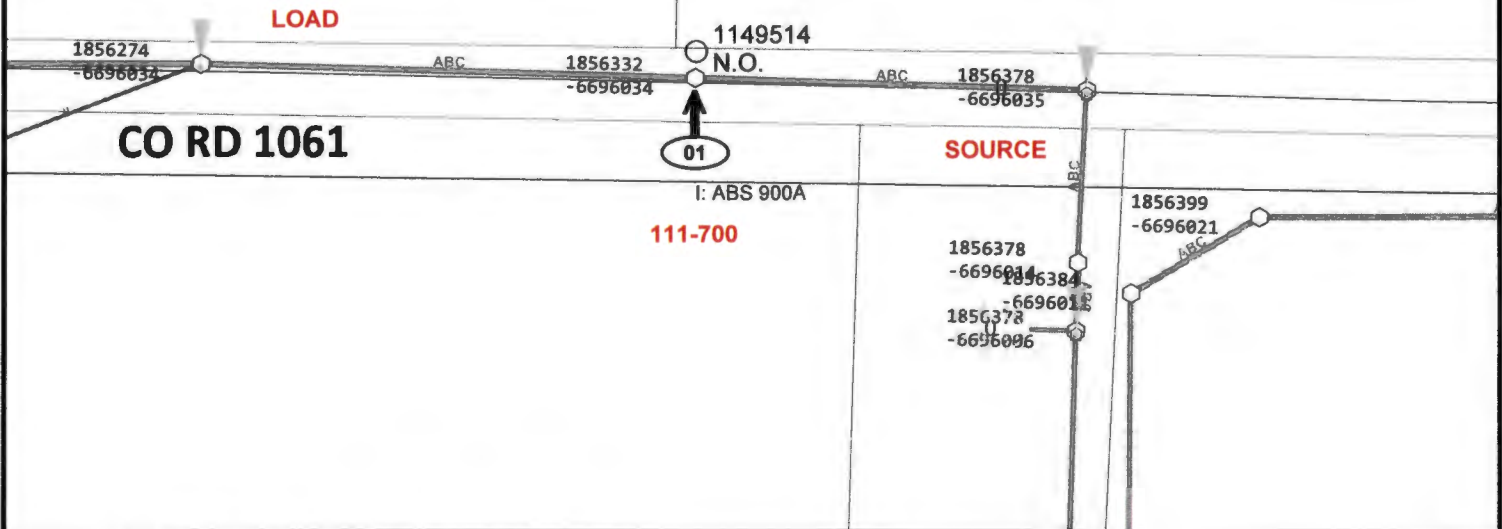

ELECTRIC CONSTRUCTION PRINT

WO Number: 30637396-01	Date: 2026/04/28	Description: CEL SRP26 CLSTE2102 DA_N PRG B ESTABLISH FEEDER BACKSTAND NWF PT1	 <p>My Supervisor: Luke McGrath TechServ Engineering & Consulting Project Coordinator (405) 826-8124 LMcGrath@TechServ.com Luke.McGrath@Oncor.com</p>
Sheet: 1 of 7	Scale: 1"=20'	Customer:	
Job Status: Design	Svc Ctr / Office: CEL/	Address: CELESTE	
Designer: RODRIGUEZ, EDDY C/UBEM	469-955-7718	Location: WS-1: (33.1699048, -96.1728847)	
Project Mgr: /			

Copyright 2018 Oncor Electric Delivery - Maps, drawings, and electronic data (products) are created for the internal purposes of Oncor Electric Delivery with no implication of suitability or fitness for the intended use of the recipient. Oncor Electric Delivery will make good faith efforts to provide products that are free from error, but does not warrant the accuracy or quality of such products. The locations shown are approximations and are not intended to show exact locations. Products provided to other parties by Oncor Electric Delivery are for the internal use of the recipient, and the recipient agrees not to duplicate or distribute the products or any portion of the products to third parties without the prior written permission of Oncor Electric Delivery. The recipient further agrees to hold harmless and indemnify Oncor Electric Delivery against all claims, costs, expenses and damages resulting from or predicated upon strict liability for personal injuries, death or property damage, on account of any defect in the property provided hereunder.

S21 - Upgrade (3) DSC 939512 to 900A
GPS: 33.2110231, -96.2042507

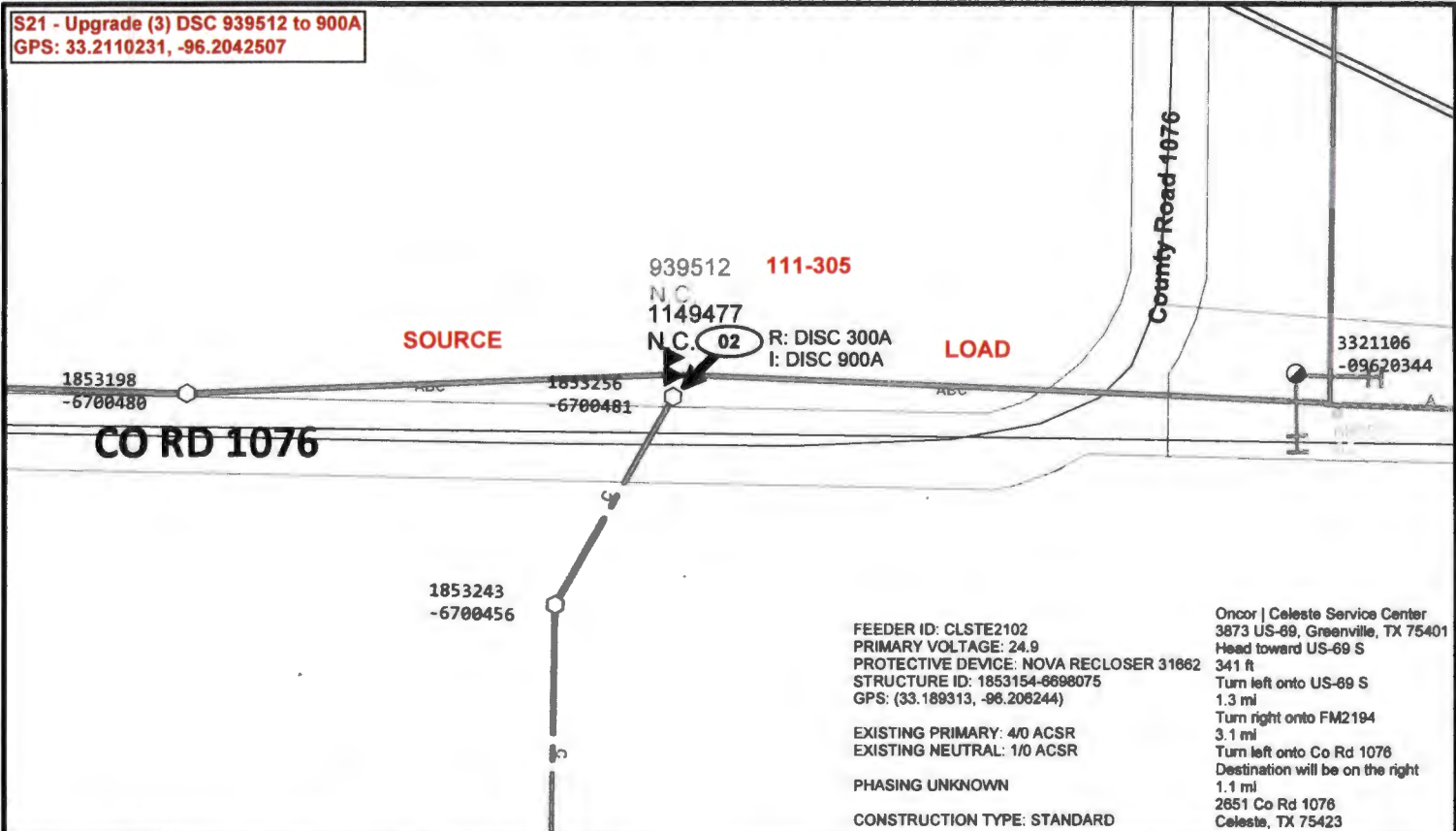

SOURCE

LOAD

939512 111-305

N.C.
1149477
N.C. 02

R: DISC 300A
I: DISC 900A

3321106
-09620344

1853198
-6700480

1853256
-6700481

CO RD 1076

1853243
-6700456

FEEDER ID: CLSTE2102
 PRIMARY VOLTAGE: 24.9
 PROTECTIVE DEVICE: NOVA RECLOSER 31682
 STRUCTURE ID: 1853154-6698075
 GPS: (33.189313, -96.206244)

EXISTING PRIMARY: 4/0 ACSR
 EXISTING NEUTRAL: 1/0 ACSR

PHASING UNKNOWN

CONSTRUCTION TYPE: STANDARD

Oncor | Celeste Service Center
 3873 US-69, Greenville, TX 75401
 Head toward US-69 S
 341 ft
 Turn left onto US-69 S
 1.3 mi
 Turn right onto FM2194
 3.1 mi
 Turn left onto Co Rd 1076
 Destination will be on the right
 1.1 mi
 2651 Co Rd 1076
 Celeste, TX 75423

ELECTRIC CONSTRUCTION PRINT

WO Number: **30637396-01**

Date: 2026/04/28

Description: CEL SRP26 CLSTE2102 DA_N PRG B ESTABLISH FEEDER BACKSTAND NWF PT1

Sheet: **2** of **7**

Scale: 1"=20'

Customer:

My Supervisor: Luke McGrath
TechServ Engineering & Consulting
Project Coordinator
(405) 826-8124
LMcGrath@TechServ.com
Luke.McGrath@Oncor.com

Job Status: **Design**

Svc Ctr / Office: **CEL/**

Address: **CELESTE**

Designer: **RODRIGUEZ, EDDY C/UBEM**

469-955-7718

Location: **WS-2: (33.2110231, -96.2042507)**

Project Mgr: /

Copyright 2018 Oncor Electric Delivery - Maps, drawings, and electronic data (products) are created for the internal purposes of Oncor Electric Delivery with no implication of suitability or fitness for the intended use of the recipient. Oncor Electric Delivery will make good faith efforts to provide products that are free from error, but does not warrant the accuracy or quality of such products. The locations shown are approximations and are not intended to show exact locations. Products provided to other parties by Oncor Electric Delivery are for the internal use of the recipient, and the recipient agrees not to duplicate or distribute the products or any portion of the products to third parties without the prior written permission of Oncor Electric Delivery. The recipient further agrees to hold harmless and indemnify Oncor Electric Delivery against all claims, costs, expenses and damages resulting from or predicated upon strict liability for personal injuries, death or property damage, on account of any defect in the property provided hereunder.



**S23 – Upgrade existing (3)
#1/0ACSR to (3) #795AAC from
GPS 33.1583438, -96.2450105 to
33.1582594, -96.2448016**

FEEDER ID: SWNDL2104
PRIMARY VOLTAGE: 24.9
PROTECTIVE DEVICE: SUBSTATION BREAKER
STRUCTURE ID: 3314186-09623503
GPS: (33.141865, -96.234517)

EXISTING PRIMARY: 1/0 ACSR
EXISTING NEUTRAL: 477 AAC

NEW PRIMARY: 795 AAC
NEW NEUTRAL: 477 AAC

PHASING UNKNOWN

CONSTRUCTION TYPE: SHIELDED

SWNDL2104

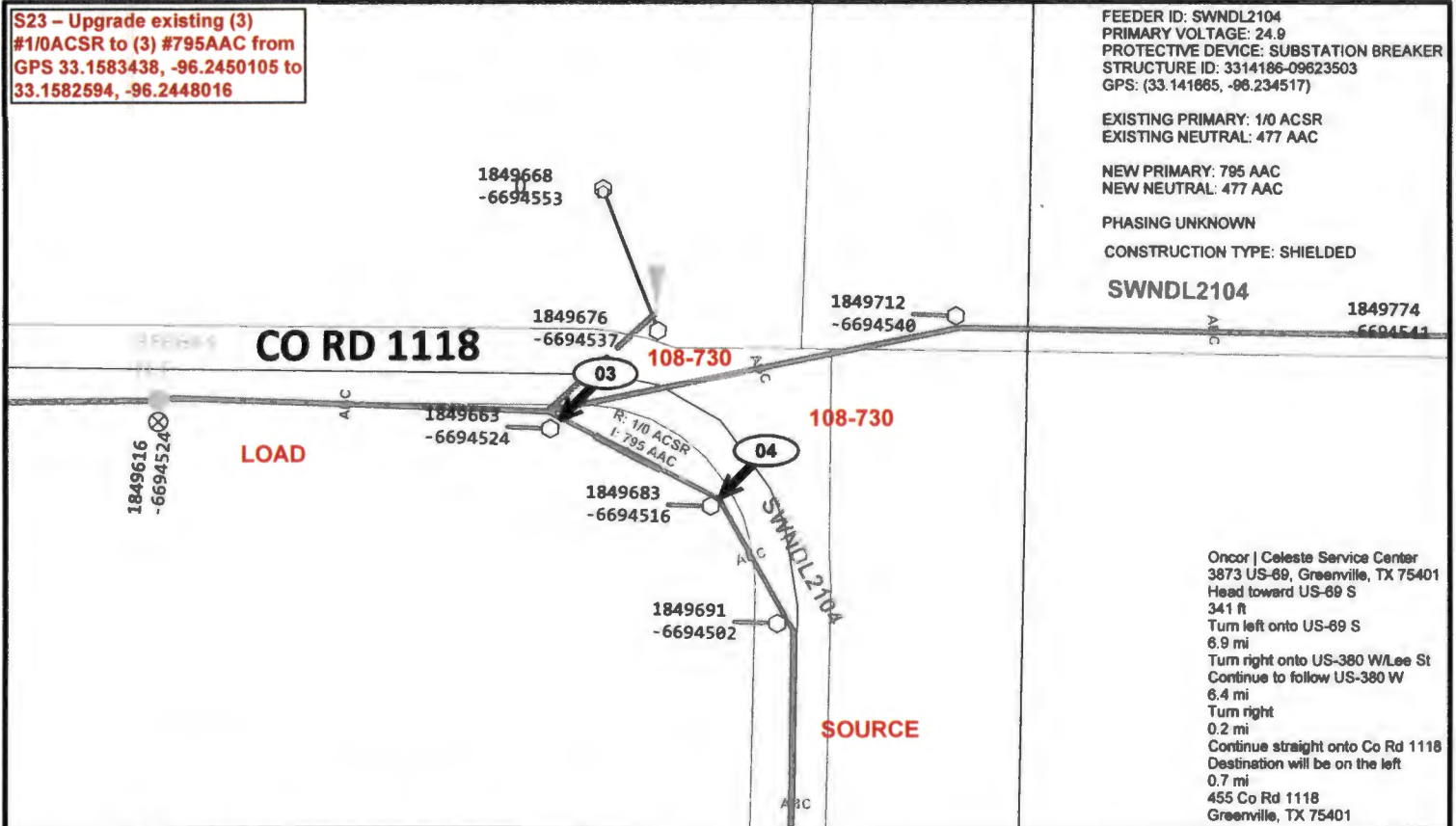

Oncor | Celeste Service Center
3873 US-69, Greenville, TX 75401
Head toward US-69 S
341 ft
Turn left onto US-89 S
6.9 mi
Turn right onto US-380 W/Lee St
Continue to follow US-380 W
6.4 mi
Turn right
0.2 mi
Continue straight onto Co Rd 1118
Destination will be on the left
0.7 mi
455 Co Rd 1118
Greenville, TX 75401

ELECTRIC CONSTRUCTION PRINT

WO Number: **30637396-01**

Date: 2026/04/28

Description: CEL SRP26 CLSTE2102 DA_N PRG B ESTABLISH FEEDER BACKSTAND NWF PT1

Sheet: **3** of **7**

Scale: 1"=20'

Customer:

My Supervisor: Luke McGrath
TechServ Engineering & Consulting
Project Coordinator
(405) 826-8124

Job Status: **Design**

Svc Ctr / Office: **CEL/**

Address: **CELESTE**

LMcGrath@TechServ.com
Luke.McGrath@Oncor.com

Designer: **RODRIGUEZ, EDDY C/UBEM**

469-955-7718

Location: **WS-3: (33.1582594, -96.2448016)**

Project Mgr: /

Copyright 2018 Oncor Electric Delivery - Maps, drawings, and electronic data (products) are created for the internal purposes of Oncor Electric Delivery with no implication of suitability or fitness for the intended use of the recipient. Oncor Electric Delivery will make good faith efforts to provide products that are free from error, but does not warrant the accuracy or quality of such products. The locations shown are approximations and are not intended to show exact locations. Products provided to other parties by Oncor Electric Delivery are for the internal use of the recipient, and the recipient agrees not to duplicate or distribute the products or any portion of the products to third parties without the prior written permission of Oncor Electric Delivery. The recipient further agrees to hold harmless and indemnify Oncor Electric Delivery against all claims, costs, expenses and damages resulting from or predicated upon strict liability for personal injuries, death or property damage, on account of any defect in the property provided hereunder.



S35 – Upgrade (3) Reg
428776_C_428777_A_428778_B to 400
Amp. GPS: 33.1771099, -96.2937864

FEEDER ID: SWNDL2104
 PRIMARY VOLTAGE: 24.9
 PROTECTIVE DEVICE: SUBSTATION BREAKER
 STRUCTURE ID: 3314186-09623503
 GPS: (33.141665, -96.234517)

EXISTING PRIMARY: 1/0 ACSR
 EXISTING NEUTRAL: 1/0 ACSR

PHASING UNKNOWN

CONSTRUCTION TYPE: STANDARD

184518
 -66964

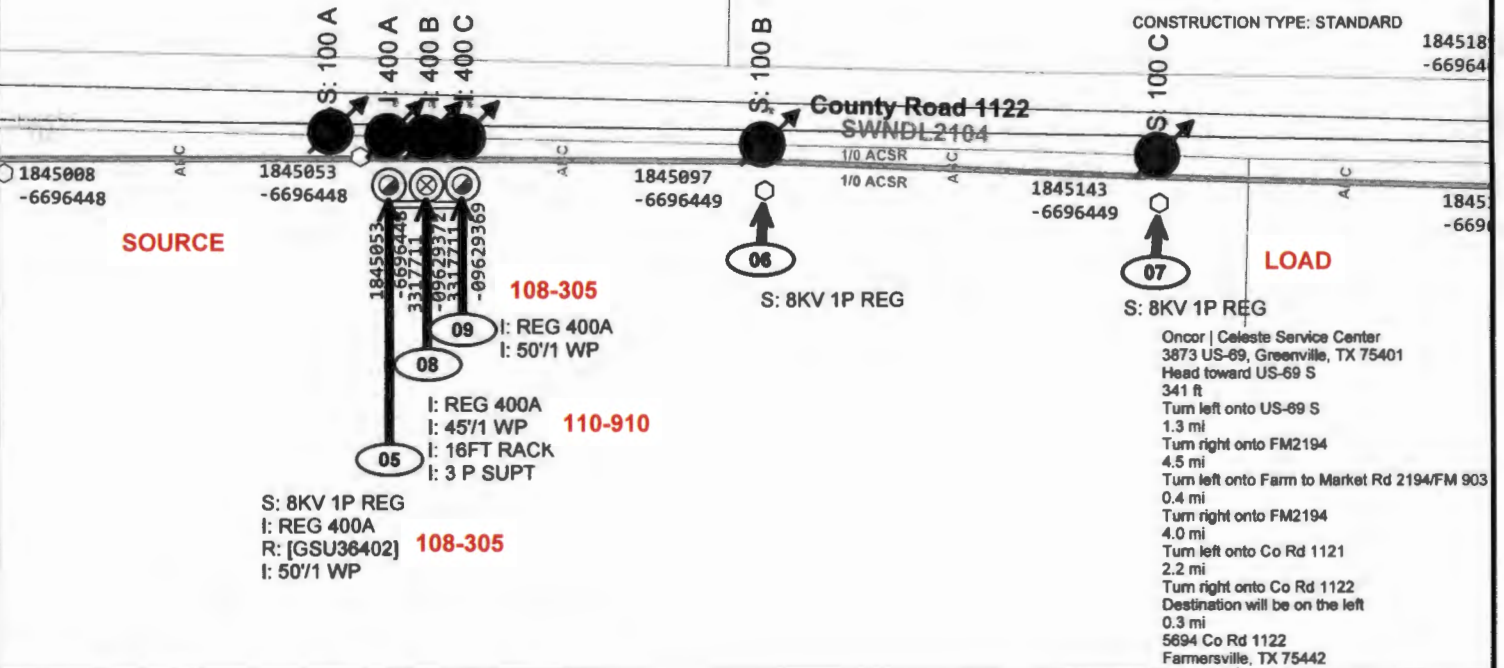

ELECTRIC CONSTRUCTION PRINT

WO Number: **30637396-01**

Date: 2026/05/11

Description: CEL SRP26 CLSTE2102 DA_N PRG B ESTABLISH FEEDER BACKSTAND NWF PT1

Sheet: **4** of **7**

Scale: 1"=20'

Customer:

My Supervisor: **Luke McGrath**
TechServ Engineering & Consulting
Project Coordinator
(405) 826-8124

Job Status: **Design**

Svc Ctr / Office: **CEL/**

Address: **CELESTE**

LMcGrath@TechServ.com
Luke.McGrath@Oncor.com

Designer: **RODRIGUEZ, EDDY C/UBEM**

469-955-7718

Location: **WS-5: (33.1771099, -96.2937864)**

Project Mgr: /

Copyright 2018 Oncor Electric Delivery - Maps, drawings, and electronic data (products) are created for the internal purposes of Oncor Electric Delivery with no implication of suitability or fitness for the intended use of the recipient. Oncor Electric Delivery will make good faith efforts to provide products that are free from error, but does not warrant the accuracy or quality of such products. The locations shown are approximations and are not intended to show exact locations. Products provided to other parties by Oncor Electric Delivery are for the internal use of the recipient, and the recipient agrees not to duplicate or distribute the products or any portion of the products to third parties without the prior written permission of Oncor Electric Delivery. The recipient further agrees to hold harmless and indemnify Oncor Electric Delivery against all claims, costs, expenses and damages resulting from or predicated upon strict liability for personal injuries, death or property damage, on account of any defect in the property provided hereunder.



**S40 – Couldn't verify setting.
Reprogram (3) TS696953 to 100P
GPS: 33.301929, -96.242615**

FEEDER ID: CLSTE2102
PRIMARY VOLTAGE: 24.9
PROTECTIVE DEVICE: TRIPSAVER
STRUCTURE ID: 1851823-6705291
GPS: (33.254852, -96.217871)

EXISTING PRIMARY/NEUTRAL: 1/0 ACSR
PHASING UNKNOWN
CONSTRUCTION TYPE: SHIELDED

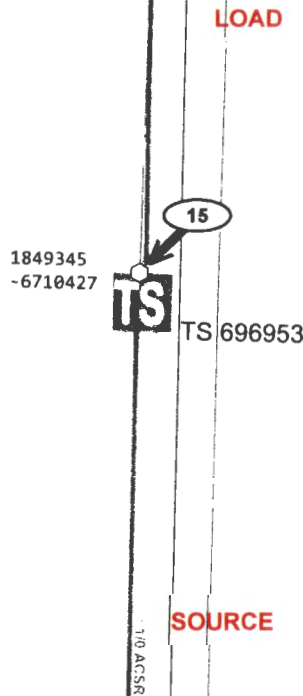

Oncor | Celeste Service Center
3873 US-69, Greenville, TX 75401
Head toward US-69 S
341 ft
Turn right onto US-69 N
4.9 mi
Turn left onto W Sanger St
72 ft
Slight left onto S 5th St
0.3 mi
Continue onto FM1562
2.7 mi
Turn right onto Co Rd 1140
459 ft
4290 FM1562
Celeste, TX 75423

ELECTRIC CONSTRUCTION PRINT

WO Number: **30637396-01**

Date: 2026/04/29

Description: CEL SRP26 CLSTE2102 DA_N PRG B ESTABLISH FEEDER BACKSTAND NWF PT1

Sheet: **6** of **7**

Scale: 1"=20'

Customer:

**My Supervisor: Luke McGrath
TechServ Engineering & Consulting
Project Coordinator
(405) 826-8124**

Job Status: **Design**

Svc Ctr / Office: **CEL/**

Address: **CELESTE**

**LMcGrath@TechServ.com
Luke.McGrath@Oncor.com**

Designer: **RODRIGUEZ, EDDY C/UBEM**

469-955-7718

Location: **WS-15: (33.301929, -96.242615)**

Project Mgr: /

Copyright 2018 Oncor Electric Delivery - Maps, drawings, and electronic data (products) are created for the internal purposes of Oncor Electric Delivery with no implication of suitability or fitness for the intended use of the recipient. Oncor Electric Delivery will make good faith efforts to provide products that are free from error, but does not warrant the accuracy or quality of such products. The locations shown are approximations and are not intended to show exact locations. Products provided to other parties by Oncor Electric Delivery are for the internal use of the recipient, and the recipient agrees not to duplicate or distribute the products or any portion of the products to third parties without the prior written permission of Oncor Electric Delivery. The recipient further agrees to hold harmless and indemnify Oncor Electric Delivery against all claims, costs, expenses and damages resulting from or predicated upon strict liability for personal injuries, death or or property damage, on account of any defect in the property provided hereunder.

